

BARREL CONTOURS



This is an example of our basic contours – but we have over 500 on file. If the one you want isn't here, please contact us with your desired dimensions.

What size barrel will serve you best? The information below will give you an idea of the size and weight of a selection of Hardy barrel contours. Shorter or longer blanks are available up to 32" - just have a chat with us.

Reminder: You must cut at least 1" off the muzzle when fitting.

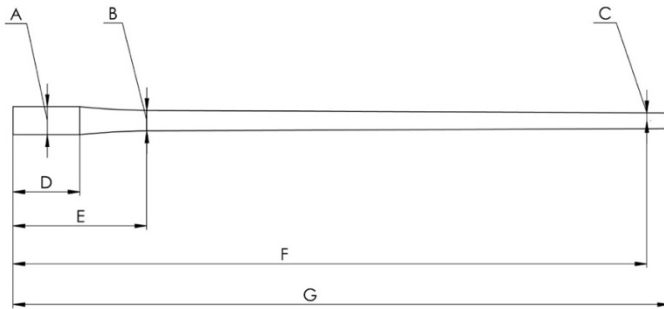

Contour #	A	B	C	D	E	F	G	Approx Weight (kg)
	Dimensions (mm)					(inches)		
No 2 – Lightweight	31.5	19.45	14.6	65	155	22"	23"	1.3kg
No 3 – Sporter	31.5	20.7	15.9	65	155	24"	25"	1.5kg
No 4 – Magnum Sporter	31.5	22.0	16.5	75	150	24"	25"	1.7kg
No 5 – Lightweight Varmint	31.5	23.1	17.8	75	150	28"	29"	2.05kg
No 6 – Medium Varmint	31.5	24.4	19.0	75	150	28"	29"	2.25kg
No 7 – Varmint	31.5	25.4	22.1	75	150	26"	27"	2.45kg
No 8 – Remington SPS	30.5	19.5	16.5	28	155	24"	25"	1.33kg
No 9 – Remington Varmint	31.5	23.85	21.1	51	116	28"	29"	2.3kg
No 10 – Remington SPS Mag	31.5	21.25	16.5	28	155	26"	27"	1.6kg
No 11 – Standard Palma	31.5	22.85	21.1	65	130	26"	27"	2.1kg
No 12 – Heavy Palma	31.5	25.40	22.9	65	130	26"	27"	2.45kg
No 13 – Tikka T3 Lite	29.0	20.0	15.8	37	80	22"	23"	1.17kg
No 14 – Heavy Bull	31.5	-	25.4	75	-	30"	31"	4.09kg
No 15 – Skimmed Blank	31.5	-	-	-	-	28"	29"	3.7kg
No 16 – Tikka T3 Varmint	29.0	22.0	22.0	52	197	28"	29"	2.2kg
Carbon Wrapped								
Remington Carbon Wrapped	31.5	25.0	24.0	79.5	132	24"	25"	1kg
Tikka Carbon Wrapped	29.0	25.0	24.1	67.0	107	24"	25"	1kg