

BARREL CONTOURS

*This is a list of our basic contours – we can actually do over **500!** If the one you want isn't here, do contact us.*



What size barrel will serve you best? The information below will give you an idea of the size and weight of every Hardy barrel contour. Shorter or longer blanks are available up to 32" - just have a chat with us.

Reminder: You must cut at least 1" off the muzzle when fitting.

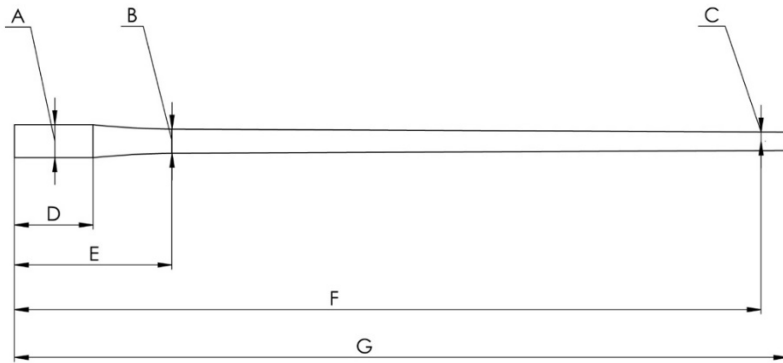

Contour #	A	B	C	D	E	F	G	Approx Weight (kg)
	Dimensions (mm)					(inches)		
No 1 – Featherweight	31.5	17.8	14.0	65	155	20"	21"	1.1kg
No 2 – Lightweight	31.5	19.45	14.6	65	155	22"	23"	1.3kg
No 3 – Sporter	31.5	20.7	15.9	65	155	24"	25"	1.5kg
No 4 – Magnum Sporter	31.5	22.0	16.5	75	150	24"	25"	1.7kg
No 5 – Lightweight Varmint	31.5	23.1	17.8	75	150	28"	29"	2.05kg
No 6 – Medium Varmint	31.5	24.4	19.0	75	150	28"	29"	2.25kg
No 7 – Varmint	31.5	25.4	22.1	75	150	26"	27"	2.45kg
No 8 – Remington SPS	30.5	19.5	16.5	28	155	24"	25"	1.33kg
No 9 – Remington Varmint	31.5	23.85	21.1	51	116	28"	29"	2.3kg
No 10 – Remington SPS Mag	31.5	21.25	16.5	28	155	26"	27"	1.6kg
No 11 – Standard Palma	31.5	22.85	21.1	65	130	26"	27"	2.1kg
No 12 – Heavy Palma	31.5	25.40	22.9	65	130	26"	27"	2.45kg
No 13 – Tikka T3 Lite	29.0	20.0	15.8	37	80	22"	23"	1.17kg
No 14 – Heavy Bull	31.5	-	25.4	75	-	30"	31"	4.09kg
No 15 – Skimmed Blank	31.5	-	-	-	-	28"	29"	3.7kg
No 16 – Tikka T3 Varmint	29.0	22.0	22.0	52	197	28"	29"	2.2kg
No 17 – Ruger Precision Rifle	30.0	25.4	19.0	38	38	26"	27"	1.85kg
No 18 – Desert Tech Arms	31.75	24.0	16.0	140	140	26"	27"	1.95kg

Carbon wrapped barrels also available